



# High-Performance Noise Barriers for the HVAC Industry



**LSE Absorptive Rooftop Enclosure**



**LSE Ground-level Enclosure**



**Elevated Rooftop Designs**



**Restricted-space Designs**

## **Highly-Effective Noise Barriers for:**

- ✓ Air Conditioners, Chillers & Evaporators
- ✓ Air and Gas Compressors
- ✓ Electric Generators
- ✓ Pumps

## **OUTSTANDING FEATURES:**

- 100% Sound Absorptive**
- Lightweight**
- Non-Corrosive, Non-Conductive**
- Easy to Install**
- Extremely Durable**
- Will Not Rust, Rot or Stain**
- Impervious to Most Chemicals**
- Available in Any Color**

[www.soundfighter.com](http://www.soundfighter.com)

# THE ULTIMATE IN NOISE CONTROL TECHNOLOGY

## LSE Noise Barrier Specifications

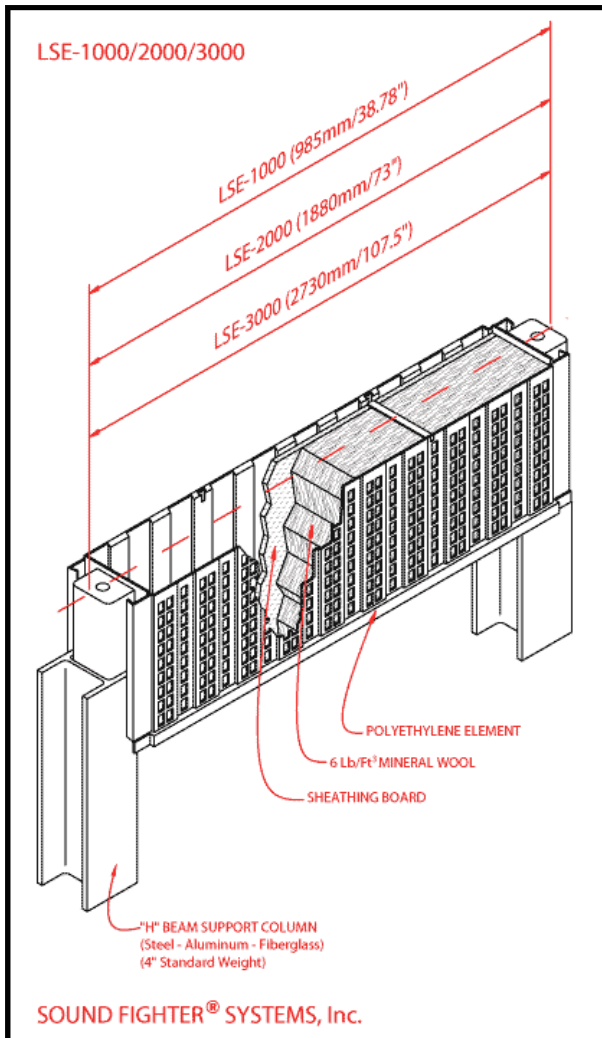

### Physical Dimensions LSE 2000

Length	73.00"
Width	6.00"
Height	10.50"
Stack Height	9.87"
Area	5.0 sf
Weight /SF	5.0 lbs.
Panel Weight	23.25 lbs.



## Certified Laboratory Acoustic Tests and Results

Acoustic Systems Acoustical Research Facility

### Sound Transmission Loss Test

Sound Transmission Loss

**33**

#### Test Method

ASTM E 90-90  
ASTM C 423-90a  
ASTM E 1332-90

### Noise Absorption Test

Noise Reduction Coefficient

**1.05**

#### Test Method

ASTM C 423-90a  
ASTM E 795-92



Sound Fighter Systems, L.L.C.  
1305 Airport Drive  
Shreveport, LA 71107

Toll Free: 866-348-0833  
Fax: 318-865-7373  
E-mail: [info@soundfighter.com](mailto:info@soundfighter.com)